

INDUSTRIAS

TODOFLEX S.R.L.

**TERMINALES PARA MANGUERA
BAJA PRESION**

www.industriastodoflex.com.ar

ventas@todoflex.com.ar

Av. Bme Mitre 4627 - (CP: 1678) - Caseros - Buenos Aires - Argentina

Tel./Fax: 4759-2778 / 4734-2477 / 4716-1078

TERMINALES PARA MANGUERA BAJA PRESIÓN

▶ RACORD MACHO FIJO ROSCA NPT

CÓDIGO	ROSCA	MANG.
A430	1/8	1/4
A431	1/8	5/16
A432	1/8	3/8
A433	1/4	1/4
A434	1/4	5/16
A435	1/4	3/8
A436	1/4	1/2
A437	3/8	1/4
A438	3/8	5/16
A439	3/8	3/8
A440	3/8	1/2
A441	3/8	5/8
A442	1/2	1/4
A443	1/2	5/16
A444	1/2	3/8
A445	1/2	1/2
A446	1/2	5/8
A447	1/2	3/4
A448	3/4	3/8
A449	3/4	1/2
A450	3/4	3/4
A451	3/4	1
A452	1	3/4
A453	1	1
A454	1 1/4	1 1/4
A455	1 1/2	1 1/2
A456	2	2

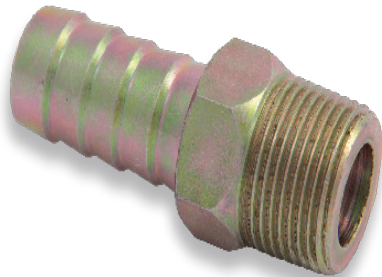

▶ RACORD HEMBRA GIRATORIA ROSCA BSP

CÓDIGO	ROSCA BSP	MANG. (pulg.)
H290	1/8	1/4
H292	1/4	1/4
H294	3/8	3/8
H295-1	3/8	1/2
H296	1/2	3/8
H298	1/2	1/2
H300	3/4	3/4
H302	1	1
H303	1 1/4	1 1/4
H304	1 1/2	1 1/2
H305	2	2

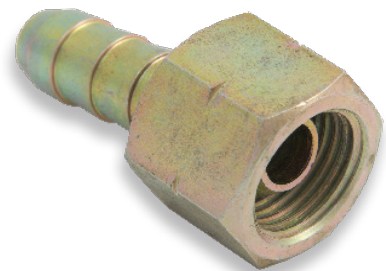

▶ RACORD MACHO FIJO ROSCA UNF

CÓDIGO	ROSCA	MANG.
M312	3/8	1/4
M314	7/16	1/4
M316	1/2	3/8
M318	9/16	3/8
M320	5/8	3/8
M322	3/4	3/8
M324	3/4	1/2
M326	7/8	1/2
M326/A	7/8	5/8
M328	1 1/16"	3/4
M330	1 5/16	1

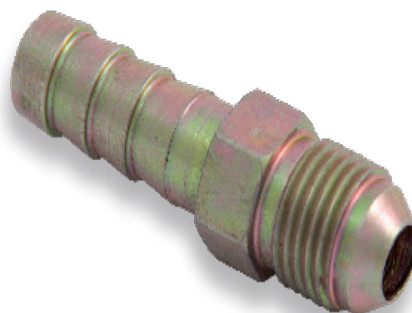

▶ RACORD HEMBRA GIRATORIA ROSCA UNF

CÓDIGO	ROSCA UNF	MANG. (pulg.)
H340	3/8	3/16
H342	3/8	1/4
H344	7/16	1/4
H346	1/2	5/16
H348	9/16	3/8
H350	5/8	3/8
H352	3/4	3/8
H354	3/4	1/2
H356	7/8	1/2
H358	1 1/16	3/4
H360	1 5/16	1
H361	1 5/8	1 1/4
H362	1 7/8	1 1/2
H363	2 1/2	2

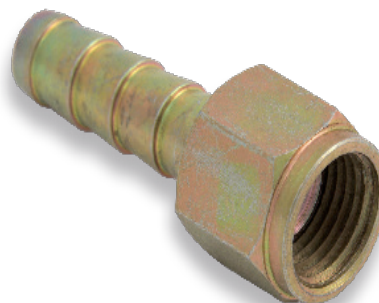

▶ VASTAGOS CONO MACHO

CÓDIGO	MEDIDA	MANG.
H420	8	3/16
H422	11	1/4
H422-A	8	1/4
H422-B	11	1/4
H424	14	5/16
H426	12	3/8
H426-A	11	3/8
H426-B	12	3/8
H426-C	17	3/8
H428	18	1/2
H428-A	16	1/2
H430	22	5/8
H430-A	19	5/8
H432	24	3/4
H434	30	1



▶ VASTAGOS CONO HEMBRA

CÓDIGO	MEDIDA	MANG.
H440	8	3/16
H442	11	1/4
H442-1	8	1/4
H442-B	9	1/4
H444	11	5/16
H446	14	3/8
H446-1	12	3/8
H446-B	11	3/8
H446-C	17	3/8
H448	18	1/2
H448-1	16	1/2
H449-A	15	1/2
H450	22	5/8
H450-1	19	5/8
H452	24	3/4
H454	30	1
H456	38	1 1/4
H457	44	1 1/2
H458	55	2



▶ BULONES PERFORADOS

CÓDIGO	MEDIDA
H459	6X1
H460	8X0,75 BEDFORD PERKINS.
H461	8X1
H462	8X1 LARGO
H463	8X1,25
H464	9,5X3/8" NF CONEXIÓN RADIAL D.P.A.
H465	10X1
H466	12X1,50
H467	13X1/2" NF PERKINS.
H468	14X1,50
H469	16X1,50
H470	18X1,50
H471	20X1,50
H472	22X1,50
H473	24X1,50

▶ OJAL PARA MANGUERA

CÓDIGO	MEDIDA (mm.)
T481-S	8 (DOBLE)
T484-S	8 (UNA SALIDA)
T486-S	10 (UNA SALIDA)
T489-S	12 (UNA SALIDA)
T491-S	13 (UNA SALIDA)
T493-S	14 (UNA SALIDA)
T495-S	16 (UNA SALIDA)



▶ CAPUCHONES DE ALUMINIO

CÓDIGO	MEDIDA	INT. (mm.)	EXT. (mm.)
T550	1/2	10,1	12,7
T551	9/16	12	14,29
T552	5/8	13,8	15,8
T553	17/42	15	17,42
T554	20/63	18	20,63
T555	3/4	16,8	19
T556	7/8	20	22,2
T557	1	23	25,4
T558	1 1/8	25,4	28
T559	1 1/4	30	32
T560	1/4	11,5	13,5



▶ CAPUCHONES DE CHAPA

CÓDIGO	MEDIDA	
	EXT. (en pulg.)	INT. (en mm.)
C210	9/16	12
C211	5/8	14
C211-1	11/16	15,5
C212	3/4	17
C212-1	13/16	18,6
C213	7/8	20
C213-1	15/16	21,8
C214	1	23
C215	1 1/8	26,5
C216	1 1/4	30
C217	1 3/8	33
C218	1 1/2	36
C219	1 5/8	39
C220	1 3/4	42,5
C221	1 7/8	42,5
C222	2	48



▶ RACORD HEMBRA DE ACERO

CÓDIGO	MANG.	ROSCA
TF2174	1/4	1/8
TF2175	5/16	1/8
TF2176	3/8	1/8
TF2177	1/4	1/4
TF2178	5/16	1/4
TF2179	3/8	1/4

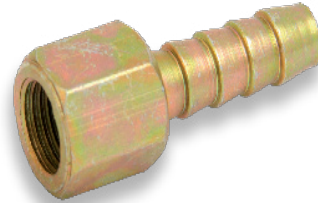

▶ RACORD DOBLE DE ACERO

CÓDIGO	MEDIDA
TF2180	1/4
TF2181	5/16
TF2182	3/8
TF2183	1/2
TF2184	5/8
TF2185	3/4



▶ RACORD TRIPLE DE ACERO

CÓDIGO	MEDIDA
TF2186	1/4
TF2187	5/16
TF2188	3/8
TF2189	1/2
TF2190	5/8
TF2191	3/4



INDUSTRIAS
TODOFLEX S.R.L.

